

# DEEMAX 09 and DEEMAX 09 12x150



**USE:** use only on a Cross Country or Cross Mountain MTB fitted with disc or rim brakes. Any other use (such as on a tandem, road bike, cyclo-cross bike, ...) is highly inadvisable, is the sole responsibility of the user and voids the Mavic warranty.

Recommended maximum weight of the cyclist and his equipment: 115 kg.

## WHEEL WEIGHTS WITHOUT QUICK-RELEASE SKEWER

	9.5x135	12x150
Front:	1010 g	1010 g
Rear:	1150 g	1160 g

## WHEEL REFERENCES

	9.5x135	12x150
Front:	996 192 10	996 192 10
Rear:	996 193 13	996 195 13
Pair:	996 194 14	996 196 14

## RIMS

**REFERENCES:** Front: 996 910 10  
Rear: 996 910 13

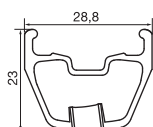

### Ø VALVE HOLE



Ø: 6.5 mm  
Length: ≥ 32 mm

### RECOMMENDED TIRE WIDTH



Dimensions: Ø 26"  
ETRTO 559 x 23C compatible and Tubeless UST.  
Recommended tire width: 2.3" to 3.0"

### When replacing the front rim:

1. With the valve hole near you, the raised indicator bump must be to the left of the valve hole
2. The spoke in the first hole to the right of the valve hole is a non-braking spoke and should be inserted in the disc side of the hub

### When replacing the rear rim:

1. With the valve hole near you, the two raised indicator bumps must be to the right of the valve hole
2. The spoke in the first hole to the right of the valve hole is a non-driving spoke and should be inserted in the drive side of the hub

## HUBS

**MAINTENANCE:** Clean with a dry cloth or soap and water if necessary.  
Do not use a high-pressure washer.

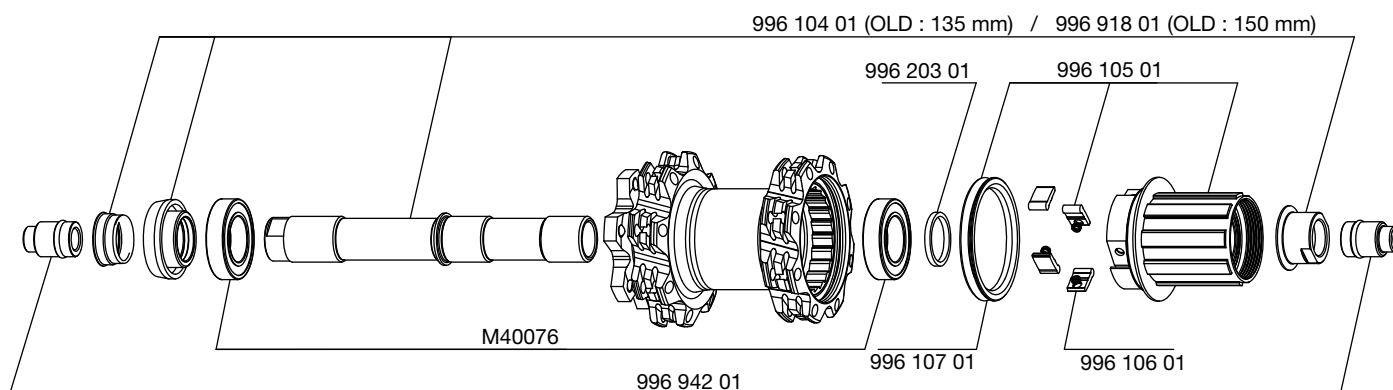
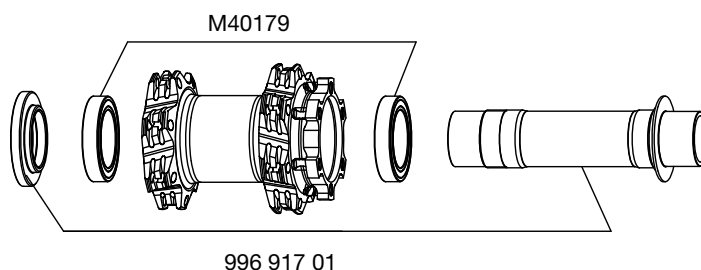

## WHEEL BUILDING

### REFERENCES AND LENGTHS:

Front:	996 911 01, length 270 mm (per 14, integrated nipples)
Rear drive side:	996 912 01, length 264.5 mm (per 16, integrated nipples)
Rear non-drive side:	996 913 01, length 267.5 mm (per 16 integrated nipples)

### FEATURES:

Black stainless steel round straight pull spokes with integrated, self-locking M7 aluminum spoke nipples.

### LACING PATTERN:

Front and rear: crossed 3 on both sides

### TENSION:

Front disc side: 100 to 120 kg  
Rear drive side: 110 to 130 kg

## ACCESSORIES

### WHEELS SUPPLIED WITH:

- BX 601 rear quick-release M40141 (with 135 mm rear wheel only)
- Axle reducers 12=>9 mm 996 942 01 (with 135 mm rear wheel only)
- UST valves 995 282 01
- M7 spoke wrench M40494 (with rear wheel)
- Free play bearing adjustment wrench M40123 (with rear wheel)
- User guide

## MAINTENANCE

Replacing the front axle and bearings  
Rear wheel assembly diameter conversion  
Maintaining and replacing the free wheel mechanism  
Replacing the rear axle and bearings  
Replacing a spoke  
Replacing the front rim  
Replacing the rear rim

See 2008 TM, page 24  
See page 25  
See page 29  
See page 30  
See page 41  
See pages 42/43  
See pages 44/45

To consult this information quickly in a practical manner, refer to [www.tech-mavic.com](http://www.tech-mavic.com)